

Carpet Boom

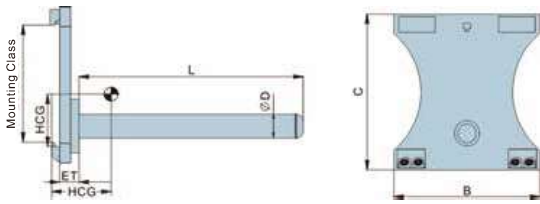

Capacity@ Load Center (Kg@mm)	Catalog Order No.	Mounting Class	Rod Diameter D	Bar Arm Length L	Weight (kg)	Effective Thickness ET (mm)	Vertical Center of Gravity VCG (mm)	Horizontal Center of Gravity HCG (mm)	Overall Width /Overall Height B/C (mm)
1000@500	CG10G-A1	II	60	1070	105	40	193	142	500/530
1000@500	CG10G-A4	II	65	1070	110	40	192	156	500/530
1000@500	CG10G-A8	II	70	1070	115	40	192	170	500/530
1000@500	CG10G-A13	II	75	2000	155	80	200	488	440/525
1000@700	CG10G-B1	III	85	1070	275	50	283	125	500/635
1000@700	CG10G-B6	III	100	1070	295	50	281	155	500/635
1500@500	CG15G-B1	III	70	1100	160	80	212	148	493/636
1500@500	CG30G-B1	III	70	1000	155	80	215	129	493/636
4500@500	CG45G-C1	IV	140	1100	400	95	326	225	680/785

Capacity@ Load Center (lbs@in)	Catalog Order No.	Mounting Class	Rod Diameter D	Bar Arm Length L	Weight (lbs)	Effective Thickness ET	Vertical Center of Gravity VCG	Horizontal Center of Gravity HCG	Overall Width /Overall Height B/C
2200@20"	CG10G-A1	II	2.4"	42.1"	231	1.6"	7.6"	5.6"	20"/20.9"
2200@20"	CG10G-A4	II	2.6"	42.1"	243	1.6"	7.6"	6.1"	20"/20.9"
2200@20"	CG10G-A8	II	2.8"	42.1"	254	1.6"	7.6"	6.7"	20"/20.9"
2200@20"	CG10G-A13	II	3"	78.7"	342	3.1"	7.9"	19.2"	17.3"/20.7"
2200@27.5"	CG10G-B1	III	3.3"	42.1"	606	2"	11.1"	4.9"	20"/25"
2200@27.5"	CG10G-B6	III	3.9"	42.1"	650	2"	11.1"	6.1"	20"/25"
3300@20"	CG15G-B1	III	2.8"	43.3"	353	3.1"	8.3"	5.8"	19.4"/25"
3300@20"	CG30G-B1	III	2.8"	39.4"	342	3.1"	8.5"	5.1"	19.4"/25"
9900@20"	CG45G-C1	IV	5.5"	43.3"	882	3.7"	12.8"	8.9"	26.8"/30.9"

Notes: Please gain the actual overall carrying capacity of forklift trucks/attachments from the forklift truck manufacturers.



Mainly used in the environmental protection industry, it can realize the rapid dumping of specific dustbins.

Sanitation Fork

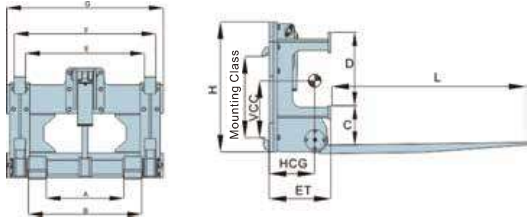

Capacity@ Load Center	Catalog Order No.	Moving Close Effective Thickness	Fork Thickness	Tilt Forward Angle α (°)	Fork Thickness	Fork Length	Fork Spacing	Frame Width	Horizontal Center of Gravity	Weight	Applicable Forklift
(Kg@mm)		ET (mm)	A/B (mm)		E/F (mm)	L/T (mm)	C/D (mm)	G/H (mm)	HCG (mm)	(kg)	(t)
3000@600	HW30G-B1 III	363	545/795	73°	835/995	1150/50	230/430	1100/762	312	420	3-4.5t
3000@600	HW30G-B2 III	363	545/795	73°	835/995	1150/50	230/478	1100/762	312	420	3-4.5t
3000@600	HW30G-B3 III	363	545/795	73°	680/840	1150/50	330/430	1100/762	312	420	3-4.5t
3000@600	HW30J-B1 III	466	545/795	73°	835/995	1220/50	230/430	1100/779	370	420	3-4.5t
3500@700	HW35J-B1 III	450	545/795	73°	835/995	1350/50	230/430	1100/779	380	495	3-4.5t

Capacity@ Load Center	Catalog Order No.	Moving Close Effective Thickness	Fork Thickness	Tilt Forward Angle α (°)	Fork Thickness	Fork Length	Fork Spacing	Frame Width	Horizontal Center of Gravity	Weight	Applicable Forklift
(lbs@in)		ET (mm)	A/B (mm)		E/F (mm)	L/T (mm)	C/D (mm)	G/H (mm)	HCG (mm)	(lbs)	(t)
6600@24"	HW30G-B1 III	14.3"	21.5"/31.3"	73°	32.9"/39.2"	45.3"/2.0"	9.1"/16.9"	43.3"/30"	12.3"	926	3-4.5t
6600@24"	HW30G-B2 III	14.3"	21.5"/31.3"	73°	32.9"/39.2"	45.3"/2.0"	9.1"/18.8"	43.3"/30"	12.3"	926	3-4.5t
6600@24"	HW30G-B3 III	14.3"	21.5"/31.3"	73°	26.8"/33.1"	45.3"/2.0"	13"/16.9"	43.3"/30"	12.3"	926	3-4.5t
6600@24"	HW30J-B1 III	18.3"	21.5"/31.3"	73°	32.9"/39.2"	48"/2.0"	9.1"/16.9"	43.3"/30.7"	14.6"	926	3-4.5t
7700@27.5"	HW35J-B1 III	17.7"	21.5"/31.3"	73°	32.9"/39.2"	53.1"/2.0"	9.1"/16.9"	43.3"/30.7"	15"	1091	3-4.5t

Notes: 1. Please gain the actual overall carrying capacity of forklift trucks/attachments from the forklift truck manufacturers.
2. Forklift truck needs to add a group of additional oil lines to match the attachments.

Model	Pressure Value Bar		Flow Value L/min	
	Min.	Max.	Min.	Recommend Max.
HW**G	35	160	19	57

Configuration of Key Parts of Truck Attachments

- Hydraulic system: all the seals adopt imported products; and the high-pressure rubber hoses adopt cone sealed high-performance imported rubber hoses.
- Structural part: the forks adopt alloy steel castings, and frame body is welded by high-performance alloy steel plated.
- Mechanical performance: it can realize 73° forward tilting, and it adds hydraulic control check valves for the oil cylinders to realize holding pressure for a long time, and further ensure the safety at work or rubber hoses burst; and it can meet the use requirements by adding a group of oil lines.
- Applicable scope: it's applied to the sites of forward tipping the cargoes efficiently, etc., especially the Sanitation Department, so as to save the time of manual handling and tipping.



Olecranon Drum Clamps is a simple attachment for handling standard iron drums. It can efficiently and stack handle the standard iron drums.