

Olecranon Drum Clamps



Capacity@ Load Center	Catalog Order No.	Overall Length	Overall Height	Weight	Frame Width	Available Forklift
(Kg@mm)		B (mm)	A (mm)	(kg)	C (mm)	(t)
500@1500	YT05G-A1	710	952	82	745	745
900@1500	YT09G-A1	1080	960	115	840	840
2000@1500	YT20G-B1	1080	980	165	840	840

Capacity@ Load Center	Catalog Order No.	Overall Length	Overall Height	Weight	Frame Width	Available Forklift
(lbs@in)		B	A	(lbs)	C	(t)
1100@59"	YT05G-A1	28"	37.5"	181	29.3"	745
1980@59"	YT09G-A1	42.5"	37.8"	254	33.1"	840
4400@59"	YT20G-B1	42.5"	38.6"	364	33.1"	840

- Notes: 1. Please gain the actual overall carrying capacity of forklift trucks/attachments from the forklift truck manufacturers.
 2. It can be used in conjunction with 1-1 Ot forklift trucks, which can be directly covered on the truck fork with convenient installation.
 3. The actual load center spacing is large, and the effective load may be only about half of the actual load.

HELI

PVC Clamp



PVC Clamp can efficiently handle and stack PVC pipe under normal temperature without pallet. Widely used in PVC industry. The functions of tipping and withhold can greatly improve the flexibility of the forklift and handling efficiency.

PVC Clamp

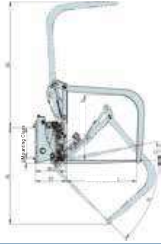
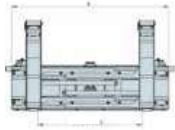

Capacity@ Load Center	Catalog Order No.	Mounting Class	Opening Range	Effective Fork Length	Pedestal Width	Plate to Pedestal spacing	Updip Height	Updip Height	Q (mm)	ET (mm)	HCG (mm)	Weight (kg)	Available Forklift
(Kg@mm)	A(mm)	L(mm)	W(mm)	H(mm)	H2 (mm)	H1 (mm)						(kg)	(t)
2000@500	QY20G-B2	III	1530-3350	1120	2240	1045	2015	1535	75	505	425	1420	3-4.5t
2000@500	QY20G-B3	III	1300-3800	1250	2520	1170	2040	1640	75	510	520	1500	3-4.5t
2000@500	QY20G-C1	IV	2440-5550	1100	2640	1160	1970	1720	130	510	520	2220	5-7t

Capacity@ Load Center	Catalog Order No.	Mounting Class	Opening Range	Effective Fork Length	Pedestal Width	Plate to Pedestal spacing	Updip Height	Updip Height	Q (mm)	ET (mm)	HCG (mm)	Weight (kg)	Available Forklift
(lbs@in)	A	L	W	H	H2	H1						(lbs)	(t)
4400@20"	QY20G-B2	III	60.2"-139.8"	44.1"	88.2"	41.1"	79.3"	60.4"	3"	19.9"	16.7"	3131	3-4.5t
4400@20"	QY20G-B3	III	51.2"-149.6"	49.2"	99.2"	46.1"	80.3"	64.6"	3"	20.1"	20.5"	3307	3-4.5t
4400@20"	QY20G-C1	IV	96.1"-218.5"	43.3"	103.9"	45.7"	77.6"	67.7"	5.1"	20.1"	20.5"	4894	5-7t

Notes: 1. Please gain the actual overall carrying capacity of forklift trucks/attachments from the forklift truck manufacturers.
2. Forklift truck needs to add a group of additional oil lines to match the attachments.

Model	Pressure Value Bar		Flow Value L/min	
	Min.	Max.	Min.	Recommand Max.
QY**G	35	160	19	38 57

Configuration of Key Parts of Truck Attachments

1. Hydraulic system: The oil cylinder adopts imported original hydraulic control one-way valve. The high - pressure hose is a high - performance inlet hose sealed with a cone.
2. Mechanical performance: External side shift function, need to be used with external cargo fork, in order to achieve forward tilt grip. Add the hydraulic control one-way valve on each oil cylinder, can achieve a long time buck teeth, to ensure the safety of work or rubber tube burst.
3. Applied range : Suitable for holding various PVC pipes to reduce logistics cost and improve production efficiency.

HELI

Hinged Steel pipe Clamp



Hinged steel pipe clamp can efficiently handle and stack hard, cylindrical objects under normal temperature without pallet. Widely used in construction, logistics industries for handling the steel pipe etc. The functions of tipping and withhold can greatly improve the flexibility of the forklift and handling efficiency.