

PVC Clamp

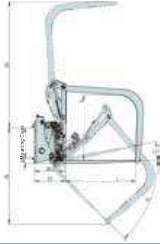
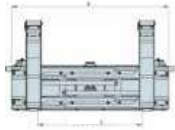

Capacity@ Load Center	Catalog Order No.	Mounting Class	Opening Range	Effective Fork Length	Pedestal Width	Plate to Pedestal spacing	Updip Height	Updip Height	Q (mm)	ET (mm)	HCG (mm)	Weight (kg)	Available Forklift
(Kg@mm)	A(mm)	L(mm)	W(mm)	H(mm)	H2 (mm)	H1 (mm)						(kg)	(t)
2000@500	QY20G-B2	III	1530-3350	1120	2240	1045	2015	1535	75	505	425	1420	3-4.5t
2000@500	QY20G-B3	III	1300-3800	1250	2520	1170	2040	1640	75	510	520	1500	3-4.5t
2000@500	QY20G-C1	IV	2440-5550	1100	2640	1160	1970	1720	130	510	520	2220	5-7t

Capacity@ Load Center	Catalog Order No.	Mounting Class	Opening Range	Effective Fork Length	Pedestal Width	Plate to Pedestal spacing	Updip Height	Updip Height	Q (mm)	ET (mm)	HCG (mm)	Weight (kg)	Available Forklift
(lbs@in)	A	L	W	H	H2	H1						(lbs)	(t)
4400@20"	QY20G-B2	III	60.2"-139.8"	44.1"	88.2"	41.1"	79.3"	60.4"	3"	19.9"	16.7"	3131	3-4.5t
4400@20"	QY20G-B3	III	51.2"-149.6"	49.2"	99.2"	46.1"	80.3"	64.6"	3"	20.1"	20.5"	3307	3-4.5t
4400@20"	QY20G-C1	IV	96.1"-218.5"	43.3"	103.9"	45.7"	77.6"	67.7"	5.1"	20.1"	20.5"	4894	5-7t

Notes: 1. Please gain the actual overall carrying capacity of forklift trucks/attachments from the forklift truck manufacturers.
2. Forklift truck needs to add a group of additional oil lines to match the attachments.

Model	Pressure Value Bar		Flow Value L/min	
	Min.	Max.	Min.	Recomm. Max.
QY**G	35	160	19	38 57

Configuration of Key Parts of Truck Attachments

1. Hydraulic system: The oil cylinder adopts imported original hydraulic control one-way valve. The high - pressure hose is a high - performance inlet hose sealed with a cone.
2. Mechanical performance: External side shift function, need to be used with external cargo fork, in order to achieve forward tilt grip. Add the hydraulic control one-way valve on each oil cylinder, can achieve a long time buck teeth, to ensure the safety of work or rubber tube burst.
3. Applied range : Suitable for holding various PVC pipes to reduce logistics cost and improve production efficiency.

HELI

Hinged Steel pipe Clamp



Hinged steel pipe clamp can efficiently handle and stack hard, cylindrical objects under normal temperature without pallet. Widely used in construction, logistics industries for handling the steel pipe etc. The functions of tipping and withhold can greatly improve the flexibility of the forklift and handling efficiency.

Hinged Steel pipe Clamp

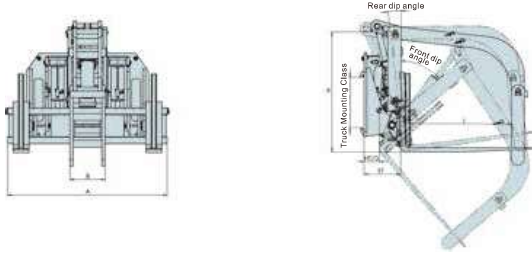

Capacity@ Load Center (Kg@mm)	Catalog Order No.	Truck Mounting Class	Hinged Fork Mounting Class	Carriage Width A (mm)	Roller Width RW (mm)	Roller Pivot Height RH (mm)	Minimum Clip L (mm)	Effective Thickness ET (mm)	Horizontal Center of Gravity HCG (mm)	Tilt Forward Tilt Backward	Weight (kg)	Available Forklift (t)
3000@500	QY30G-B1	III	Non-standard fork	1500	345	1100	970	345	350	50°/10°	870	3-4.5t
5000@600	QY50G-C4	IV	Non-standard fork	1785	275	1170	970	385	350	45°/10°	960	5-7t
2500@600	QY25G-B6	III	Non-standard fork	1380	345	1100	970	335	430	50°/10°	700	3-4.5t
2500@500	QY25G-B7	III	Standard fork	1380	310	1090	980	380	430	50°/10°	545	3-4.5t
5000@500	QY50G-C6	IV	Non-standard fork	1785	390	871	819	470	450	50°/10°	1040	5-7t

Capacity@ Load Center (lbs@in)	Catalog Order No.	Truck Mounting Class	Hinged Fork Mounting Class	Carriage Width A	Roller Width RW	Roller Pivot Height RH	Minimum Clip L	Effective Thickness ET	Horizontal Center of Gravity HCG	Tilt Forward Tilt Backward	Weight (lbs)	Available Forklift (t)
6600@20"	QY30G-B1	III	Non-standard fork	59.1"	13.6"	43.3"	38.2"	13.6"	13.8"	50°/10°	1918	3-4.5t
11000@23.6"	QY50G-C4	IV	Non-standard fork	70.3"	10.8"	46.1"	38.2"	15.2"	13.8"	45°/10°	2116	5-7t
5500@23.6"	QY25G-B6	III	Non-standard fork	54.3"	13.6"	43.3"	38.2"	13.2"	16.9"	50°/10°	1543	3-4.5t
5500@20"	QY25G-B7	III	Standard fork	54.3"	12.2"	42.9"	38.6"	15"	16.9"	50°/10°	1202	3-4.5t
5000@500	QY50G-C6	IV	Non-standard fork	70.3"	15.4"	34.3"	32.3"	18.5"	17.7"	50°/10°	2292	5-7t

- Notes: 1. Please gain the actual overall carrying capacity of forklift trucks/attachments from the forklift truck manufacturers.
2. Forklift truck needs to add two groups of additional oil lines to match the attachments, and all the oil cylinders have self-locking functions.

Model	Pressure Value Bar		Flow Value L/min	
	Min.	Max.	Min.	Recomend Max.
QY**G	35	160	19	38 57

Configuration of Key Parts of Truck Attachments

- Hydraulic system: the oil cylinders adopt originally imported hydraulic control check valves; all the seals adopt imported products; and the high-pressure rubber hoses adopt cone sealed high-performance imported rubber hoses.
- Structural part: the fork carriages are welded by high-performance alloy steel plates.
- Mechanical performance: it can realize 45° forward tilting and 19° backward tilting; and it adds hydraulic control check valves for the oil cylinders to realize holding pressure for a long time, and further ensure the safety at work or rubber hoses burst.
- Applicable scope: it's applied to the transportation/tipping by clamping various round pieces of wood and round clothes, etc., which reduces the logistics costs and increases the production efficiency significantly.



The hinged broke handler is able to enlarge the upward and downward tilt angle of fork carriage (Upward 20°-25° , down 45°), and the arms will hold the goods to avoid damages in transit. Moreover, the hinged broke handler used with containers, such as bucket, will dump the bulk cargo from the bucket efficiently and safely. It is widely used in recycling, and waste management, greatly improve the flexubility of loading and unloading of the forklift.