

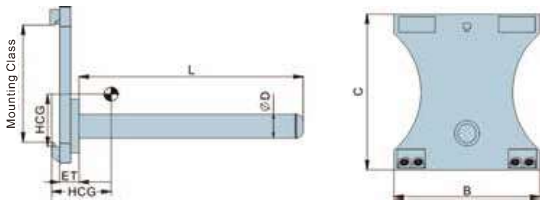

## Carpet Boom



Capacity@ Load Center (Kg@mm)	Catalog Order No.	Mounting Class	Rod Diameter D	Bar Arm Length L	Weight (kg)	Effective Thickness ET (mm)	Vertical Center of Gravity VCG (mm)	Horizontal Center of Gravity HCG (mm)	Overall Width /Overall Height B/C (mm)
1000@500	CG10G-A1	II	60	1070	105	40	193	142	500/530
1000@500	CG10G-A4	II	65	1070	110	40	192	156	500/530
1000@500	CG10G-A8	II	70	1070	115	40	192	170	500/530
1000@500	CG10G-A13	II	75	2000	155	80	200	488	440/525
1000@700	CG10G-B1	III	85	1070	275	50	283	125	500/635
1000@700	CG10G-B6	III	100	1070	295	50	281	155	500/635
1500@500	CG15G-B1	III	70	1100	160	80	212	148	493/636
1500@500	CG30G-B1	III	70	1000	155	80	215	129	493/636
4500@500	CG45G-C1	IV	140	1100	400	95	326	225	680/785

Capacity@ Load Center (lbs@in)	Catalog Order No.	Mounting Class	Rod Diameter D	Bar Arm Length L	Weight (lbs)	Effective Thickness ET	Vertical Center of Gravity VCG	Horizontal Center of Gravity HCG	Overall Width /Overall Height B/C
2200@20"	CG10G-A1	II	2.4"	42.1"	231	1.6"	7.6"	5.6"	20"/20.9"
2200@20"	CG10G-A4	II	2.6"	42.1"	243	1.6"	7.6"	6.1"	20"/20.9"
2200@20"	CG10G-A8	II	2.8"	42.1"	254	1.6"	7.6"	6.7"	20"/20.9"
2200@20"	CG10G-A13	II	3"	78.7"	342	3.1"	7.9"	19.2"	17.3"/20.7"
2200@27.5"	CG10G-B1	III	3.3"	42.1"	606	2"	11.1"	4.9"	20"/25"
2200@27.5"	CG10G-B6	III	3.9"	42.1"	650	2"	11.1"	6.1"	20"/25"
3300@20"	CG15G-B1	III	2.8"	43.3"	353	3.1"	8.3"	5.8"	19.4"/25"
3300@20"	CG30G-B1	III	2.8"	39.4"	342	3.1"	8.5"	5.1"	19.4"/25"
9900@20"	CG45G-C1	IV	5.5"	43.3"	882	3.7"	12.8"	8.9"	26.8"/30.9"

Notes: Please gain the actual overall carrying capacity of forklift trucks/attachments from the forklift truck manufacturers.



Mainly used in the environmental protection industry, it can realize the rapid dumping of specific dustbins.